

EH & TS / LICENSING SECTION
RECEIVED
 06 DEC 2016
 TO:

Application to vary a premises licence under the Licensing Act 2003

PLEASE READ THE FOLLOWING INSTRUCTIONS FIRST

Before completing this form please read the guidance notes at the end of the form. If you are completing this form by hand please write legibly in block capitals. In all cases ensure that your answers are inside the boxes and written in black ink. Use additional sheets if necessary.

You may wish to keep a copy of the completed form for your records.

I/We Greene King Retailing Ltd

(Insert name(s) of applicant)

being the premises licence holder, apply to vary a premises licence under section 34 of the Licensing Act 2003 for the premises described in Part 1 below

Premises licence number PR00464

Part 1 – Premises Details

Postal address of premises or, if none, ordnance survey map reference or description			
Royal Hotel Royal Parade Ross-on-Wye			
Post town	Ross-on-Wye	Postcode	HR9 5HZ

Telephone number at premises (if any)	01989 565105
Non-domestic rateable value of premises	£79,500

Part 2 – Applicant details

Daytime contact telephone number	
E-mail address (optional)	
Current postal address if different from premises address	
Post town	

[Type text]

Part 3 - Variation

Please tick as appropriate

Do you want the proposed variation to have effect as soon as possible?

Yes

No

If not, from what date do you want the variation to take effect?

DD	MM	YYYY

Please describe briefly the nature of the proposed variation (Please see guidance note 1)

To vary the licensing plans to extend the external patio area, for full and further details please view the licensing plans.

If your proposed variation would mean that 5,000 or more people are expected to attend the premises at any one time, please state the number expected to attend:

[Type text]

Part 4 Operating Schedule

Please complete those parts of the Operating Schedule below which would be subject to change if this application to vary is successful.

Please tick all that apply

Provision of regulated entertainment

- a) plays (if ticking yes, fill in box A)
- b) films (if ticking yes, fill in box B)
- c) indoor sporting events (if ticking yes, fill in box C)
- d) boxing or wrestling entertainment (if ticking yes, fill in box D)
- e) live music (if ticking yes, fill in box E)
- f) recorded music (if ticking yes, fill in box F)
- g) performances of dance (if ticking yes, fill in box G)
- h) anything of a similar description to that falling within (e), (f) or (g) (if ticking yes, fill in box H)

-
-
-
-
-
-
-
-

Provision of late night refreshment (if ticking yes, fill in box I)

Sale by retail of alcohol (if ticking yes, fill in box J)

In all cases complete boxes K, L and M

-
-

[Type text]

A

Plays Standard days and timings (please read guidance note 6)			Will the performance of a play take place indoors or outdoors or both – please tick (please read guidance note 2)	Indoors	<input type="checkbox"/>
Day	Start	Finish		Outdoors	<input type="checkbox"/>
Mon				Both	<input type="checkbox"/>
Tue			Please give further details here (please read guidance note 3)		
Wed			State any seasonal variations for performing plays (please read guidance note 4)		
Thur			Non standard timings. Where you intend to use the premises for the performance of plays at different times to those listed in the column on the left, please list (please read guidance note 5)		
Fri					
Sat					
Sun					

[Type text]

B

Films Standard days and timings (please read guidance note 6)			<u>Will the exhibition of films take place indoors or outdoors or both – please tick</u> (please read guidance note 2)	Indoors	<input type="checkbox"/>
Day	Start	Finish		Outdoors	<input type="checkbox"/>
Mon				Both	<input type="checkbox"/>
Tue			<u>Please give further details here</u> (please read guidance note 3)		
Wed			<u>State any seasonal variations for the exhibition of films</u> (please read guidance note 4)		
Thur					
Fri			<u>Non standard timings. Where you intend to use the premises for the exhibition of films at different times to those listed in the column on the left, please list</u> (please read guidance note 5)		
Sat					
Sun					

[Type text]

C

Indoor sporting events Standard days and timings (please read guidance note 6)			<u>Please give further details</u> (please read guidance note 3)
Day	Start	Finish	
Mon			<u>State any seasonal variations for indoor sporting events</u> (please read guidance note 4)
Tue			
Wed			<u>Non standard timings. Where you intend to use the premises for indoor sporting events at different times to those listed in the column on the left, please list</u> (please read guidance note 5)
Thur			
Fri			
Sat			
Sun			

[Type text]

D

Boxing or wrestling entertainments Standard days and timings (please read guidance note 6)			Will the boxing or wrestling entertainment take place indoors or outdoors or both – please tick (please read guidance note 2)	Indoors	<input type="checkbox"/>
Day	Start	Finish		Outdoors	<input type="checkbox"/>
				Both	<input type="checkbox"/>
Mon			<u>Please give further details here</u> (please read guidance note 3)		
Tue					
Wed			<u>State any seasonal variations for boxing or wrestling entertainment</u> (please read guidance note 4)		
Thur					
Fri			<u>Non standard timings. Where you intend to use the premises for boxing or wrestling entertainment at different times to those listed in the column on the left, please list</u> (please read guidance note 5)		
Sat					
Sun					

[Type text]

E

Live music Standard days and timings (please read guidance note 6)			<u>Will the performance of live music take place indoors or outdoors or both – please tick</u> (please read guidance note 2)	Indoors	<input type="checkbox"/>
Day	Start	Finish		Outdoors	<input type="checkbox"/>
				Both	<input type="checkbox"/>
Mon			<u>Please give further details here</u> (please read guidance note 3)		
Tue					
Wed			<u>State any seasonal variations for the performance of live music</u> (please read guidance note 4)		
Thur					
Fri			<u>Non standard timings. Where you intend to use the premises for the performance of live music at different times to those listed in the column on the left, please list</u> (please read guidance note 5)		
Sat					
Sun					

[Type text]

F

Recorded music Standard days and timings (please read guidance note 6)			<u>Will the playing of recorded music take place indoors or outdoors or both – please tick</u> (please read guidance note 2)	Indoors	<input type="checkbox"/>			
				Outdoors	<input type="checkbox"/>			
				Both	<input type="checkbox"/>			
Day	Start	Finish	<u>Please give further details here</u> (please read guidance note 3)					
Mon								
Tue								
Wed						<u>State any seasonal variations for the playing of recorded music</u> (please read guidance note 4)		
Thur								
Fri						<u>Non standard timings. Where you intend to use the premises for the playing of recorded music at different times to those listed in the column on the left, please list</u> (please read guidance note 5)		
Sat								
Sun								

[Type text]

G

Performances of dance Standard days and timings (please read guidance note 6)			<u>Will the performance of dance take place indoors or outdoors or both – please tick</u> (please read guidance note 2)	Indoors	<input type="checkbox"/>
Day	Start	Finish		Outdoors	<input type="checkbox"/>
				Both	<input type="checkbox"/>
Mon			<u>Please give further details here</u> (please read guidance note 3)		
Tue					
Wed			<u>State any seasonal variations for the performance of dance</u> (please read guidance note 4)		
Thur					
Fri			<u>Non standard timings. Where you intend to use the premises for the performance of dance at different times to those listed in the column on the left, please list</u> (please read guidance note 5)		
Sat					
Sun					

[Type text]

H

Anything of a similar description to that falling within (e), (f) or (g) Standard days and timings (please read guidance note 6)			Please give a description of the type of entertainment you will be providing		
Day	Start	Finish	Will this entertainment take place indoors or outdoors or both – please tick (please read guidance note 2)	Indoors	<input type="checkbox"/>
Mon				Outdoors	<input type="checkbox"/>
				Both	<input type="checkbox"/>
Tue			Please give further details here (please read guidance note 3)		
Wed					
Thur			State any seasonal variations for entertainment of a similar description to that falling within (e), (f) or (g) (please read guidance note 4)		
Fri					
Sat			Non standard timings. Where you intend to use the premises for the entertainment of a similar description to that falling within (e), (f) or (g) at different times to those listed in the column on the left, please list (please read guidance note 5)		
Sun					

[Type text]

I

Late night refreshment Standard days and timings (please read guidance note 6)			Will the provision of late night refreshment take place indoors or outdoors or both – please tick (please read guidance note 2)	Indoors	<input type="checkbox"/>
Day	Start	Finish		Outdoors	<input type="checkbox"/>
				Both	<input type="checkbox"/>
Mon			Please give further details here (please read guidance note 3)		
Tue					
Wed			State any seasonal variations for the provision of late night refreshment (please read guidance note 4)		
Thur					
Fri			Non standard timings. Where you intend to use the premises for the provision of late night refreshment at different times, to those listed in the column on the left, please list (please read guidance note 5)		
Sat					
Sun					

[Type text]

J

Supply of alcohol Standard days and timings (please read guidance note 6)			Will the supply of alcohol be for consumption – please tick (please read guidance note 7)	On the premises	<input type="checkbox"/>
				Off the premises	<input type="checkbox"/>
Day	Start	Finish		Both	<input type="checkbox"/>
Mon			<u>State any seasonal variations for the supply of alcohol</u> (please read guidance note 4) As per the premises licence granted		
Tue					
Wed					
Thur			<u>Non-standard timings. Where you intend to use the premises for the supply of alcohol at different times to those listed in the column on the left, please list</u> (please read guidance note 5)		
Fri					
Sat					
Sun					

K

<p>Please highlight any adult entertainment or services, activities, other entertainment or matters ancillary to the use of the premises that may give rise to concern in respect of children (please read guidance note 8).</p>

[Type text]

L

Hours premises are open to the public Standard days and timings (please read guidance note 6)			<u>State any seasonal variations</u> (please read guidance note 4) As per the premises licence granted
Day	Start	Finish	
Mon			
Tue			
Wed			
Thur			
Fri			
Sat			
Sun			
			<u>Non standard timings. Where you intend the premises to be open to the public at different times from those listed in the column on the left, please list</u> (please read guidance note 5)

Please identify those conditions currently imposed on the licence which you believe could be removed as a consequence of the proposed variation you are seeking.

[Type text]

Please tick as appropriate

- I have enclosed the premises licence
- I have enclosed the relevant part of the premises licence

If you have not ticked one of these boxes, please fill in reasons for not including the licence or part of it below

Reasons why I have not enclosed the premises licence or relevant part of premises licence.

[Type text]

M

Describe any additional steps you intend to take to promote the four licensing objectives as a result of the proposed variation:

a) General – all four licensing objectives (b, c, d and e) (please read guidance note 9)

As per premises licence granted

b) The prevention of crime and disorder

As per premises licence granted

c) Public safety

As per premises licence granted

d) The prevention of public nuisance

As per premises licence granted

e) The protection of children from harm

As per premises licence granted

[Type text]

Checklist:

Please tick to indicate agreement

- I have made or enclosed payment of the fee.
- I have sent copies of this application and the plan to responsible authorities and others where applicable.
- I understand that I must now advertise my application.
- I have enclosed the premises licence or relevant part of it or explanation.
- I understand that if I do not comply with the above requirements my application will be rejected.

IT IS AN OFFENCE, LIABLE ON SUMMARY CONVICTION TO A FINE NOT EXCEEDING LEVEL 5 ON THE STANDARD SCALE, UNDER SECTION 158 OF THE LICENSING ACT 2003, TO MAKE A FALSE STATEMENT IN OR IN CONNECTION WITH THIS APPLICATION.

Part 5 – Signatures (please read guidance note 10)

Signature of applicant (the current premises licence holder) or applicant's solicitor or other duly authorised agent (please read guidance note 11). **If signing on behalf of the applicant, please state in what capacity.**

Signature	[Redacted]
Date	5 th December 2016
Capacity	Licensing Manager

Where the premises licence is jointly held, signature of 2nd applicant (the current premises licence holder) or 2nd applicant's solicitor or other authorised agent (please read guidance note 12). **If signing on behalf of the applicant, please state in what capacity.**

Signature	
Date	
Capacity	

Contact name (where not previously given) and address for correspondence associated with this application (please read guidance note 13)

Post town		Post code	
Telephone number (if any)			
If you would prefer us to correspond with you by e-mail, your e-mail address (optional)			

[Type text]

Notes for Guidance

This application cannot be used to vary the licence so as to extend the period for which the licence has effect or to vary substantially the premises to which it relates. If you wish to make that type of change to the premises licence, you should make a new premises licence application under section 17 of the Licensing Act 2003.

1. Describe the premises. For example the type of premises, its general situation and layout and any other information which could be relevant to the licensing objectives. Where your application includes off-supplies of alcohol and you intend to provide a place for consumption of these off-supplies, you must include a description of where the place will be and its proximity to the premises.
2. Where taking place in a building or other structure please tick as appropriate (indoors may include a tent).
3. For example state type of activity to be authorised, if not already stated, and give relevant further details, for example (but not exclusively) whether or not music will be amplified or unamplified.
4. For example (but not exclusively), where the activity will occur on additional days during the summer months.
5. For example (but not exclusively), where you wish the activity to go on longer on a particular day e.g. Christmas Eve.
6. Please give timings in 24 hour clock (e.g. 16:00) and only give details for the days of the week when you intend the premises to be used for the activity.
7. If you wish people to be able to consume alcohol on the premises, please tick 'on the premises'. If you wish people to be able to purchase alcohol to consume away from the premises, please tick 'off the premises'. If you wish people to be able to do both, please tick 'both'.
8. Please give information about anything intended to occur at the premises or ancillary to the use of the premises which may give rise to concern in respect of children regardless of whether you intend children to have access to the premises, for example (but not exclusively) nudity or semi-nudity, films for restricted age groups or the presence of gaming machines.
9. Please list here steps you will take to promote all four licensing objectives together.
10. The application form must be signed.
11. An applicant's agent (for example solicitor) may sign the form on their behalf provided that they have actual authority to do so.
12. Where there is more than one applicant, each of the applicants or their respective agents must sign the application form.
13. This is the address which we shall use to correspond with you about this application.

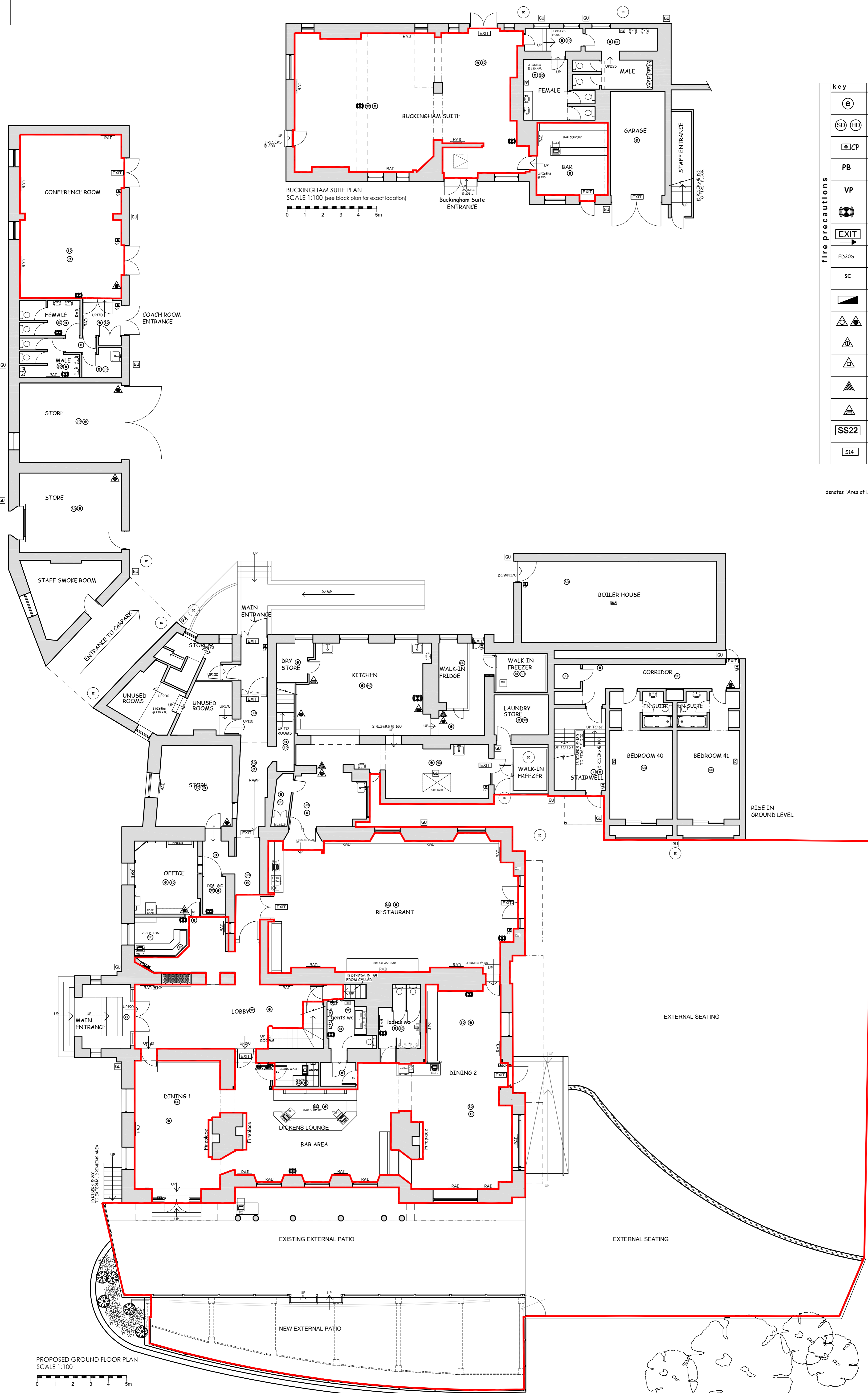
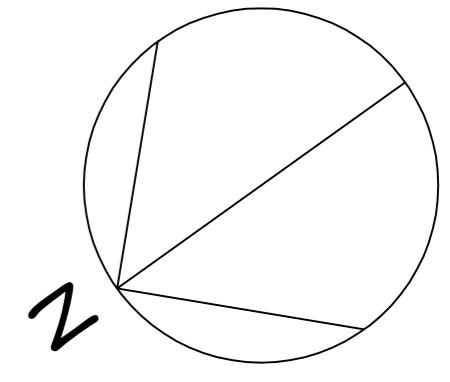

key	description
(E)	area covered by non-maintained emergency luminaire (bs 5266)
(SD) (HD)	area covered by heat/smoke detector (bs 5839)
(CP)	manual call point (bs 5839)
PB	Push bar or single action fastening to be available when the premises are in use
VP	vision panel
(X)	area covered by visible warning indicator & sounder at high level (bs 5839)
(EXIT)	internally illuminated 'fire exit' or graphic equivalent - 75mm high letters (bs 5499) arrow indicates directional FIRE EXIT
FD30S	30 min fire resistant doorset with intumescent strip, smoke seal & self closer: upgrade/replace existing if required
SC	self closing - opening force limited to 20 newtons to comply with Building Regulations Doc. M
(FAP)	fire alarm panel
(A)	fire extinguisher: Aqueous Film Forming Foam / Foam type
(W)	fire extinguisher: water type
(D)	fire extinguisher: dry powder
(C)	fire extinguisher: carbon dioxide gas
(B)	fire extinguisher: fire blanket
SS22	door to be securely fixed open whilst members of the public are on the premises
S14	Sign 'Fire Door Keep Locked' to BS 5499

denotes 'Area of Licensable Activity'

- FIRE SAFETY PROVISIONS**
- ALL FIRE RESISTING DOORS AND PARTITIONS TO BE IN ACCORDANCE WITH BS 476 PART 8.
 - FD30 DOORS TO BE FITTED WITH SMOKE SEALS TO COMPLY WITH SMOKE PRESSURIZATION TEST IN BS 476 SECTION 31.1.
 - FIRE ALARM SYSTEM TO COMPLY WITH BS 5839.
 - EMERGENCY LIGHTING INSTALLATION TO COMPLY WITH BS 5266 PART 1.
 - PHOTO LUMINESCENT SIGNS TO COMPLY WITH BS 5499 PART 2. ILLUMINATED FIRE EXIT SIGNS TO COMPLY WITH BS 5499 PART 3 & CONSTRUCTED IN ACCORDANCE WITH BS 4533 PART 101.
 - FIRE FIGHTING EQUIPMENT TO COMPLY WITH BS 5306.
 - FIRE SAFETY SIGNS & NOTICES TO COMPLY WITH EC SAFETY SIGNS DIRECTIVE 92/58 C.
 - WALL & CEILING LININGS TO BE CLASS 1 SURFACE SPREAD OF FLAME IN PUBLIC AREAS AS DEFINED IN BS 476 PART 7. ALL CEILING LININGS TO ESCAPE ROUTES TO BE CLASS 0 SURFACE SPREAD OF FLAME IN ACCORDANCE WITH BUILDING REGULATIONS PART B.
 - UPHOLSTERED FURNITURE TO SATISFY IGNITION SOURCE 0 (CIGARETTE TEST), STANDARD CRIB TEST & STANDARD CRIB IGNITION SOURCE 5 AS DEFINED IN BS 5852: 1990.
 - FABRICS TREATED WITH FLAME RETARDER TO BE SUBJECT TO WATER SOAK TEST AS DEFINED IN BS 5651. INDEPENDENT CERTIFICATION OF THE ABOVE STANDARD TO BE PROVIDED BY AN ACCREDITED TEST ORGANISATION.
 - CURTAINS AND DRAPES TO SATISFY TYPE B PERFORMANCE REQUIREMENT AS DEFINED IN BS 5867 PART 2.
 - ARTIFICIAL FOLIAGE AND OTHER DECORATIVE EFFECTS TO BE FIRE RETARDANT TO THE SATISFACTION OF THE FIRE AUTHORITY.
 - VERTICALLY HUNG TEXTILES TO BE IGNITION TESTED TO BS 5438 TEST 2.
 - TEXTILE FLOOR COVERINGS TO BE IGNITION TESTED TO BS 4790.
 - ALL INTERNAL WALL AND CEILING MOUNTED TIMBER FEATURES AND BOARDING TO BE TREATED WITH INTUMESCENT COATING TO ACHIEVE CLASS 1 SPREAD OF FLAME IN ACCORDANCE WITH BUILDING REGULATIONS PART B.
 - STRUCTURAL BEAMS SUPPORTING FIRST FLOOR/SECOND FLOOR CONSTRUCTION TO BE ENCASED IN FIRE RESISTANT CLADDING TO ACHIEVE 1 HOUR FIRE RESISTANCE IN ACCORDANCE WITH BS 476 PART 21 AND BUILDING REGULATIONS PART B.
 - STRUCTURAL STEELWORK SUPPORTING ROOF STRUCTURE TO BE PROTECTED TO 1/2 HOUR FIRE RESISTANCE IN ACCORDANCE WITH BS 476 PART 21 & BUILDING REGULATIONS PART B.
 - SIGNS TO BE DISPLAYED ON ESCAPE ROUTE AS FOLLOWS:
FD 30 SC DOORS - FIRE DOOR KEEP SHUT
FIRE EXIT DOORS - FIRE EXIT KEEP CLEAR
SECURITY DOORS - DOORS TO BE SECURED OPEN WHEN PREMISES IN USE
 - INSTRUCTIONS TO STAFF IN CASE OF FIRE NOTICE TO BE PROVIDED.
 - DURING HOURS OF OPERATION THE KITCHEN EXIT, YARD GATES, CELLAR EXIT, SLIDING DOORS AT BOTTOM OF STAIRS AND SMOKE LOBBY TO BE OPERATED BY A SINGLE ACTION AND WITHOUT THE USE OF A KEY.
 - PRIMARY LIGHTING SHOULD BE PROVIDED TO ILLUMINATE THE EXTERNAL ESCAPE ROUTE IN ACCORDANCE WITH THE FIRE AUTHORITY.

E:	
D:	
C:	
B:	
A:	

REVISION

HUNTER PATEL CREATIVE GROUP

BRIDGE HOUSE • STATION ROAD • LICHFIELD
STAFFORDSHIRE • WS13 6HX
TEL: 01543 258 600 FAX: 01543 258 611
E-MAIL: DESIGN@HUNTERPATELCREATIVEGROUP.COM

Client
GREENE KING OEI

Job
THE ROYAL HOTEL
ROYAL PARADE
ROSS-ON-WYE

Drawing Title
PROPOSED LICENSING PLAN

Date
NOVEMBER 2016

Scale
1:100 @ A1

DRAWN BY
KS

JOB No
1888

DRG No
06

This drawing is the property of Hunter Patel Creative Group. Copyright is reserved by them and the drawing is issued on the condition that it is not copied either wholly or in part without the consent in writing of Hunter Patel Creative Group. Figured dimensions to take preference over those scaled. All dimensions to be checked on site before commencement of any work or shop drawings. This is to be read in conjunction with the specifications when existing.